

WD76-25

30" Stainless Steel Warming Drawer



The perfect solution for multi-tasking. Not only will it warm your plates, the keep warm function maintains a set of temperature of 80°C - ideal for keeping food warm until ready to serve without drying out your food.



Features

- 30" wide stainless steel warming drawer
- Touch-open : no handle
- 4 programs (defrost, proofing dough, crockery warming, food warming)
- 9.8" (25cm) high
- 15 place setting capacity

Functions

- Defrosting
- Proving Dough Cups / Glasses Warming
- Crockery Warming
- Food Warming

Load Capacity

- 12 Place Setting Capacity
- 12 x 24cm Dinner Plate
- 12 x 10cm Soup Bowls
- 1 x 19cm Serving Dish
- 1 x 17cm Serving Dish
- 2 x 32cm Meat Plates
- 2 x 32cm Meat Plates

Specifications

Product Dimensions (W/H/D)

- 29^{13/16"} / 9^{7/8"} / 22^{1/16"}
- 758mm / 251mm / 560mm

Cut Out Dimensions (W/H/D)

- 28^{3/8"} / 10" / min. 23^{5/8"}
- 720mm / 261mm / 600mm

Electrical Requirements

- 110 V / 60 Hz / 15 Amp
- Supplied with a 6.5ft cord and plug
- NEMA 6-15R required

WD76-25

Specifications



Install Details

Front

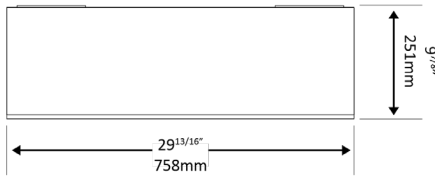

Side

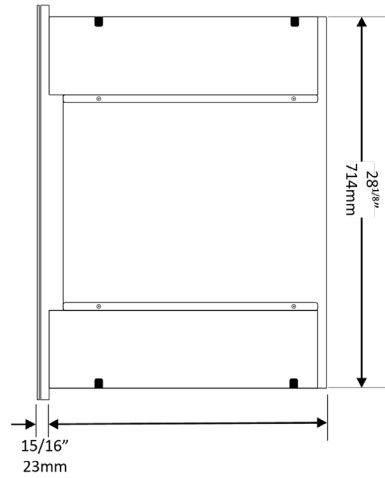
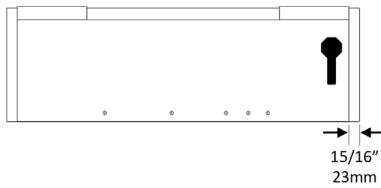
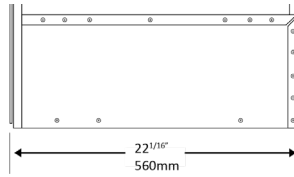

Specifications

Product Dimensions (W/H/D)

- 29^{13/16}" / 9^{7/8}" / 22^{1/16}"
- 758mm / 251mm / 560mm

Cut Out Dimensions (W/H/D)

- 28^{3/8}" / 10" / min. 23^{5/8}"
- 720mm / 261mm / 600mm

Electrical Requirements

- 110 V / 60 Hz / 15 Amp
- Supplied with a 6.5ft cord and plug
- NEMA 6-15R required

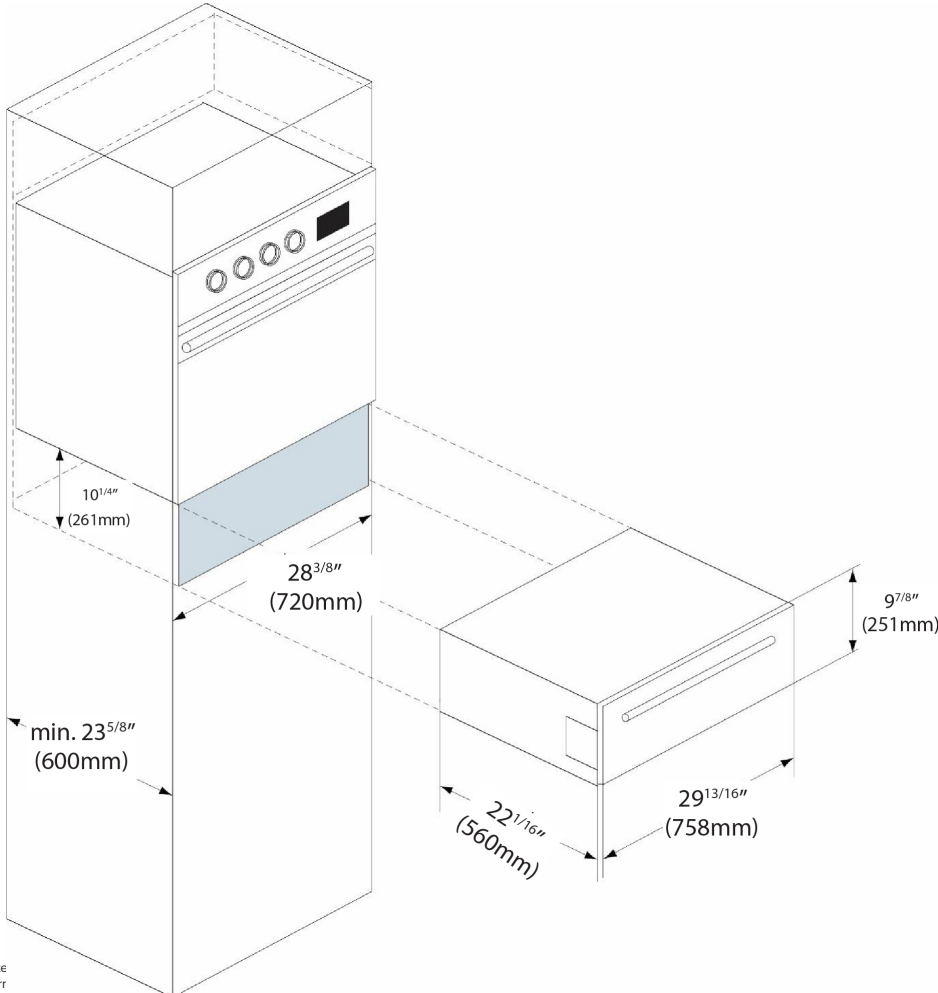

Other Product Downloads Available at porterandcharles.ca

- [Download Operation-Installation Manual](#)



WARRANTY INFORMATION

Porter & Charles Appliances are designed and manufactured to the highest standards. Each appliance is covered by a comprehensive 2-year parts and labour warranty. Refer to product warranty policy for complete terms and conditions.

FOR PARTS & SERVICE

Euro-Parts & Service
39822 Belgrave Road, Belgrave, ON. N0G 1E0 1 866 722 2262
www.euro-parts.ca • parts@euro-parts.ca • service@euro-parts.ca

Porter & Charles appliances are imported and distributed in North America by Euro-Line Appliances Inc. For more information, please visit one of our showrooms or www.ela.ca / www.elawest.ca

EURO-LINE APPLIANCES INC.

871 Cranberry Court, Oakville, ON
L6L 6J7 Canada
905 829 3980
1 800 421 6332
info@ela.ca

EURO-LINE APPLIANCES INC.

101-1014 Homer Street, Vancouver, BC
V6B 2W9, Canada
604 235 3980
1 855 ELA WEST (352 9378)
info@elawest.ca